

1723 GEORGE WASHINGTON MEMORIAL HWY

YORKTOWN, VA 23693



THALHIMER

Office/Warehouse For Lease

Former Chase  
Roofing Space



Clay Culbreth | Senior Vice President | [clay.culbreth@thalhimer.com](mailto:clay.culbreth@thalhimer.com) | 757 407 2424



1723 GEORGE WASHINGTON MEMORIAL HWY

YORKTOWN, VA 23693

## SITE

- 2.66 acres
- Direct exposure to George Washington Memorial Highway (Route 17) – signage above entrance and at street to be paid for by Tenant
  - 33,250 vehicles per day on GWMH
- Zoned GB - General Business
  - Permitted use information provided upon request
- Utilities to the site – water (included in rent), electric, no gas, septic
- Ample parking in front
- Ample laydown yard in rear

## LEASING INFORMATION

- **\$8 PSF, NNN for warehouse space**
- **\$12 PSF, NNN for office space**
- Landlord prefers to lease entire 18,900 SF; however, will consider leasing Warehouse B (7,500 SF) separate, if office and Warehouse A are leased
- First month's rent and security deposit equal to first month's rent are due upon lease signature
- 5-year lease preferred
- Operating expenses estimated at \$0.60 PSF



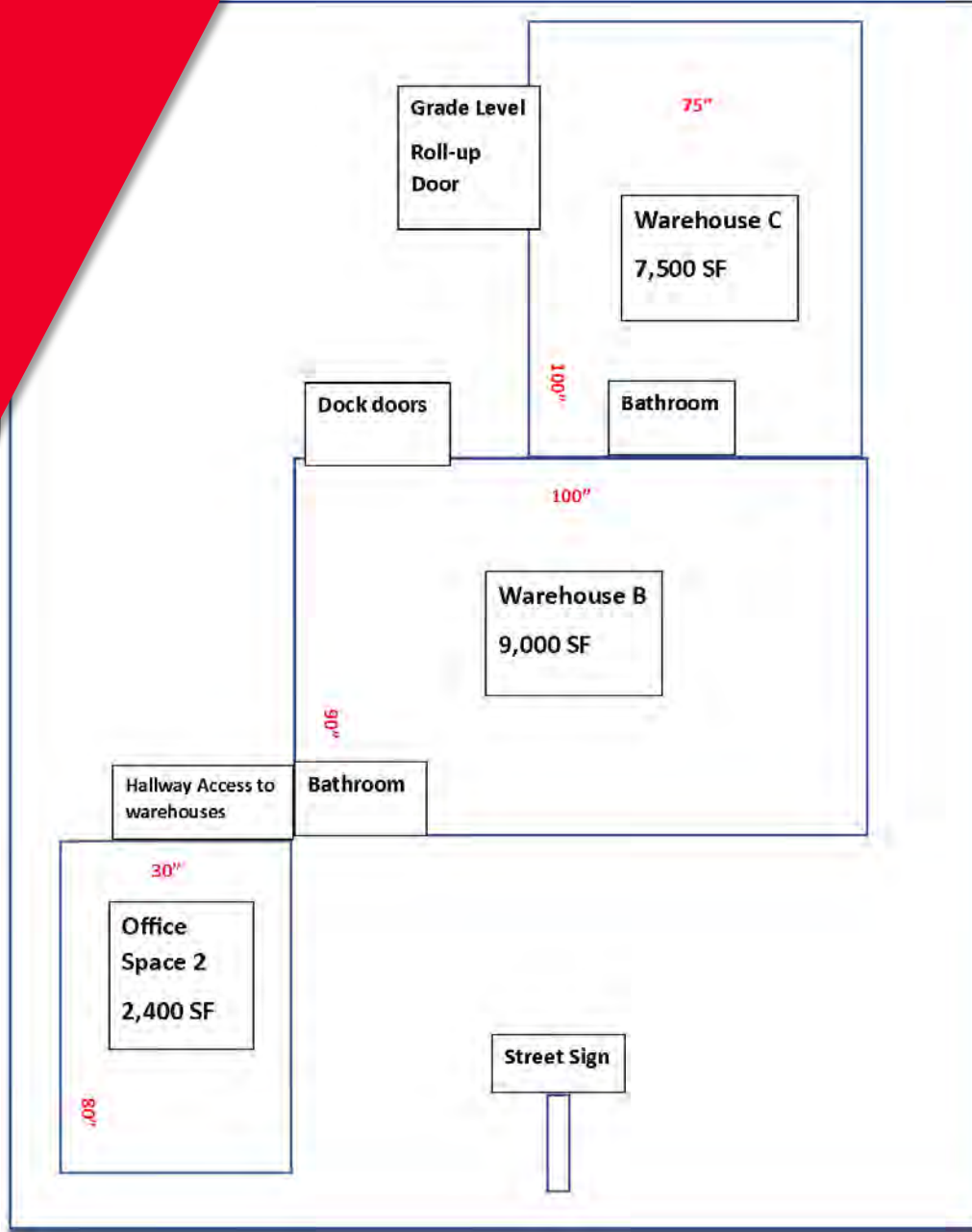

## BUILDING

- 18,900 SF total
  - Office space
    - 2,400 SF
    - Recent construction
    - Four large private offices
    - Nice reception area
    - Very large bullpen/kitchen/meeting room
    - 200 amp, 3 phase service
    - Men's and women's
  - Warehouse B
    - 9,000 SF
    - Warehouse office
    - Fully insulated
    - Skylights
    - 25 new LED lights recently installed
    - 3 phase power
    - Two (2) dock level doors (10'x10')
    - 22' – 25' clear
    - Small overhead space heater
    - Access to Warehouse C via 10' x 14' opening
    - Restroom
  - Warehouse C
    - 7,500 SF
    - No office or heat; ADA restroom
    - Fully insulated
    - New high bay LED lights recently installed
    - Wall fans
    - Large grade level door (10'w x 14'h)
    - 16' – 18'5" clear
    - Free span



1723 GEORGE WASHINGTON MEMORIAL HWY

YORKTOWN, VA 23693



Door and grade level loading

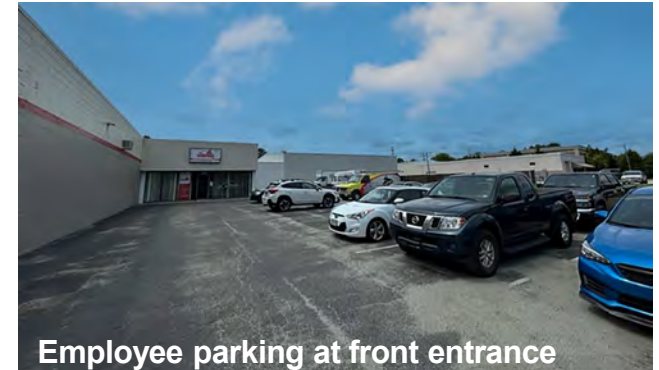

Employee parking at front entrance



Laydown yard



1723 GEORGE WASHINGTON MEMORIAL HWY

YORKTOWN, VA 23693



THALHIMER

Ample Laydown Yard



Clay Culbreth | Senior Vice President | [clay.culbreth@thalhimer.com](mailto:clay.culbreth@thalhimer.com) | 757 407 2424

Thalhimer  
222 Central Park Avenue  
Virginia Beach, VA 23462  
[www.thalhimer.com](http://www.thalhimer.com)

*Independently Owned and Operated / A Member of the Cushman & Wakefield Alliance*

*Cushman Wakefield | Thalhimer © 2023. No warranty or representation, express or implied, is made to the accuracy or completeness of the information contained herein, and same is submitted subject to errors, omissions, change of price, rental or other conditions, withdrawal without notice, and to any special listing conditions, imposed by the property owner(s). As applicable, we make no representation as to the condition of the property (or properties) in question.*